

Integrated Profile System | IPS

Easy to install! If you cut and install crown molding, you can install IPS.



Easy as 1,2,3.

1. **Measure** width of opening.
2. **Cut** the aluminum profiles to length with miter saw.*
3. **Install** with tool-less clips.



*You have the option to have the profiles pre-cut for your installation. However, cutting the profiles yourself can insure better fit.

Optional End Caps

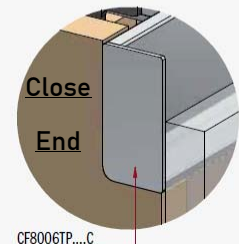
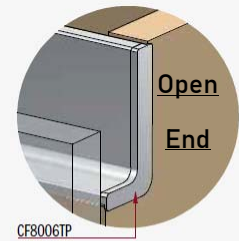

1 DOWELED SUPPORT



4 ADD FIXING CLIP



2 PUSH SUPPORT IN



5 TURN CLIP

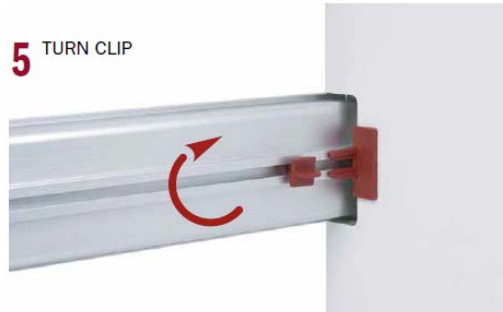

3 ADD "GOLA" PROFILE



6 PUSH AND LOCK

